

EURO-WALL, LLC

EURO C5 OUT FOLDING DOOR SYSTEM (NON-HVHZ) (NON-IMPACT)

euro-wall
SUPERIOR BY DESIGN

EURO-WALL, LLC
P.O. BOX 8007
NORTH PORT, FL 34290
PH: 888-989-3876

GENERAL NOTES:

- THE PRODUCT SHOWN HEREIN IS DESIGNED AND MANUFACTURED TO COMPLY WITH THE CURRENT FLORIDA BUILDING CODE (FBC), **EXCLUDING** HVHZ AND HAS BEEN EVALUATED ACCORDING TO THE FOLLOWING:
 - ASTM E283-04(12)
 - ASTM E330-14
 - ASTM E547-00
 - AAMA 1304-02
- ADEQUACY OF THE EXISTING STRUCTURAL CONCRETE/MASONRY, 2X AND METAL STUD FRAMING AS A MAIN WIND FORCE RESISTING SYSTEM CAPABLE OF WITHSTANDING AND TRANSFERRING APPLIED PRODUCT LOADS TO THE FOUNDATION IS THE RESPONSIBILITY OF THE ENGINEER OR ARCHITECT OF RECORD FOR THE PROJECT OF INSTALLATION.
- 1X AND 2X BUCKS (WHEN USED) SHALL BE DESIGNED AND ANCHORED TO PROPERLY TRANSFER ALL LOADS TO THE STRUCTURE. BUCK DESIGN AND INSTALLATION IS THE RESPONSIBILITY OF THE ENGINEER OR ARCHITECT OF RECORD FOR THE PROJECT OF INSTALLATION.
- THE INSTALLATION DETAILS DESCRIBED HEREIN ARE GENERIC AND MAY NOT REFLECT ACTUAL CONDITIONS FOR A SPECIFIC SITE. IF SITE CONDITIONS CAUSE INSTALLATION TO DEVIATE FROM THE REQUIREMENTS DETAILED HEREIN, A LICENSED ENGINEER OR ARCHITECT SHALL PREPARE SITE SPECIFIC DOCUMENTS FOR USE WITH THIS DOCUMENT.
- APPROVED IMPACT PROTECTIVE SYSTEM IS **REQUIRED** TO PROTECT THIS PRODUCT IN AREAS REQUIRING IMPACT RESISTANCE.
- DOOR FRAME MATERIAL: *EXTRUDED ALUMINUM (6063-T5)*.
- GLASS MEETS THE REQUIREMENTS OF ASTM E1300 GLASS CHARTS. SEE SHEET 1 FOR GLAZING DETAIL.
- DOORS SHALL USE SERIES EURO-C5 CARRIES, HINGES, PIVOTS, TWIN POINTS AND LEVER LOCKSET AND SERIES EURO-DSD MULTI-POINT DOOR LOCKS PER MANUFACTURERS REQUIREMENTS FOR EACH CONFIGURATION.

NOTE: WHEN INSTALLED AT A LOCATION PROTECTED BY AN OVERHANG SUCH THAT:
OVERHANG (OH) RATIO = OH LENGTH ÷ OH HEIGHT IS ≥ 1.0 ,
WATER INFILTRATION REQUIREMENT DOES NOT NEED TO BE MET

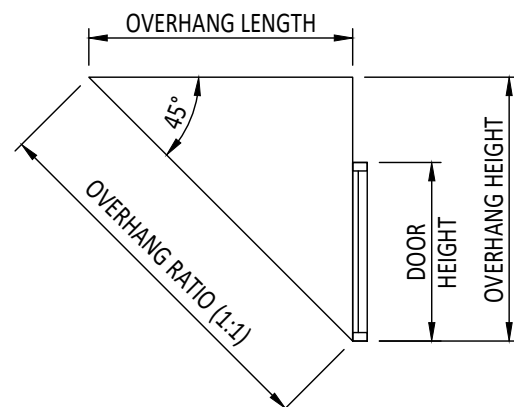

| TABLE OF CONTENTS | |
|-------------------|---|
| SHEET | SHEET DESCRIPTION |
| 1 | GENERAL NOTES & GLAZING DETAIL |
| 2 | ELEVATIONS |
| 3 | DESIGN PRESSURE TABLE |
| 4 | ANCHOR LAYOUT |
| 5 | VERTICAL SECTIONS |
| 6 | HORIZONTAL SECTIONS |
| 7 | INSTALLATION NOTES, ANCHOR DETAILS & SCHEDULE |

| DESIGN PRESSURE RATING | | | |
|--|---------------|-----------------|-----------------------|
| O.A SIZE | CONFIGURATION | DESIGN PRESSURE | MISSILE IMPACT RATING |
| SEE SHEET 3 | SEE SHEET 3 | SEE SHEET 3 | NON-IMPACT |
| SEE SHEET 2 FOR ADDITIONAL CONFIGURATION INFORMATION | | | |
| SEE SHEET 4 FOR WATER RATING INFORMATION | | | |

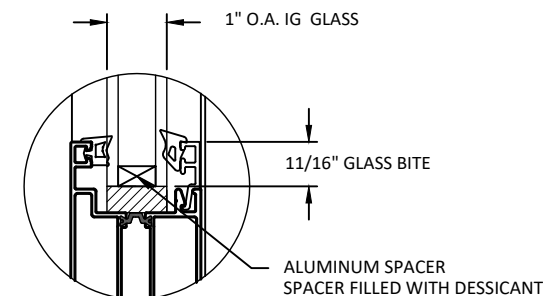

GLAZING DETAIL 1

- NOTE:
- ALL GLAZING CONFIGURATIONS SHALL COMPLY WITH SAFETY GLAZING REQUIREMENTS OUTLINED IN CURRENT FBC AND ASTM E 1300 GLASS CHART REQUIREMENTS.
 - SETTING BLOCK SHOULD BE 70-90 DUROMETER AS PER CH 24 OF THE CURRENT FBC.
 - GLASS LITES THAT EXCEED 36" IN WIDTH SHALL USE SETTING BLOCKS AT $\frac{1}{4}$ SPAN FROM CORNERS.

TITLE:
EURO C5 OUT FOLDING DOOR SYSTEM
(NON-HVHZ) (NON-IMPACT)

GENERAL AND GLAZING DETAILS

PREPARED BY:
BUILDING DROPS, INC.

1900 NE MIAMI COURT, STE. 2-15
MIAMI, FL 33132
PH: (954) 399-8478
FAX: (954) 474-4738
WEB: www.buildingdrops.com



| REMARKS | BY | DATE |
|-------------------|----|-------|
| 2023 CODE CHANGE | MG | 02/23 |
| COMPANY NAME UPD. | SH | 09/23 |
| DP TABLE UPDATES | SH | 12/23 |

THE INSTALLATION DETAILS DESCRIBED HEREIN ARE GENERIC AND MAY NOT REFLECT ACTUAL CONDITIONS FOR A SPECIFIC SITE. IF SITE CONDITIONS CAUSE INSTALLATION TO DEVIATE FROM THE REQUIREMENTS DETAILED HEREIN, A LICENSED ENGINEER OR ARCHITECT SHALL PREPARE SITE SPECIFIC DOCUMENTS FOR USE WITH THIS DOCUMENT.

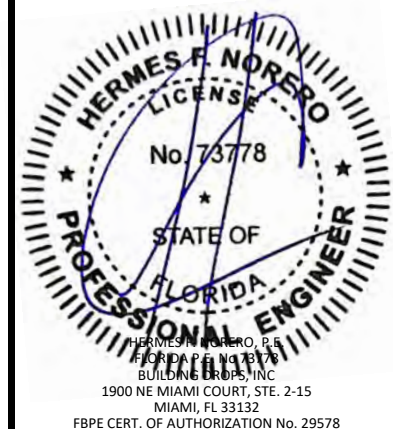

FL #:

FL27023

DATE: 04.06.18

DWG. BY: HR

CHK. BY: HFN

SCALE: NTS

DWG. #: EWS008

SHEET:

1

OF 7

s:\projects\euro-wall systems\fbc-23-1121 - fbc submittal - non-impact aluminum products design pressure table updates\dwgs\127023\ews008.dwg

EURO-WALL, LLC
P.O. BOX 8007
NORTH PORT, FL 34290
PH: 888-989-3876

TITLE:
EURO C5 OUT FOLDING DOOR SYSTEM
(NON-HVHZ) (NON-IMPACT)

ELEVATIONS

PREPARED BY:
BUILDING DROPS, INC.
1900 NE MIAMI COURT, STE. 2-15
MIAMI, FL 33132
PH: (954)399-8478
FAX: (954)744-4738
WEB: www.buildingdrops.com

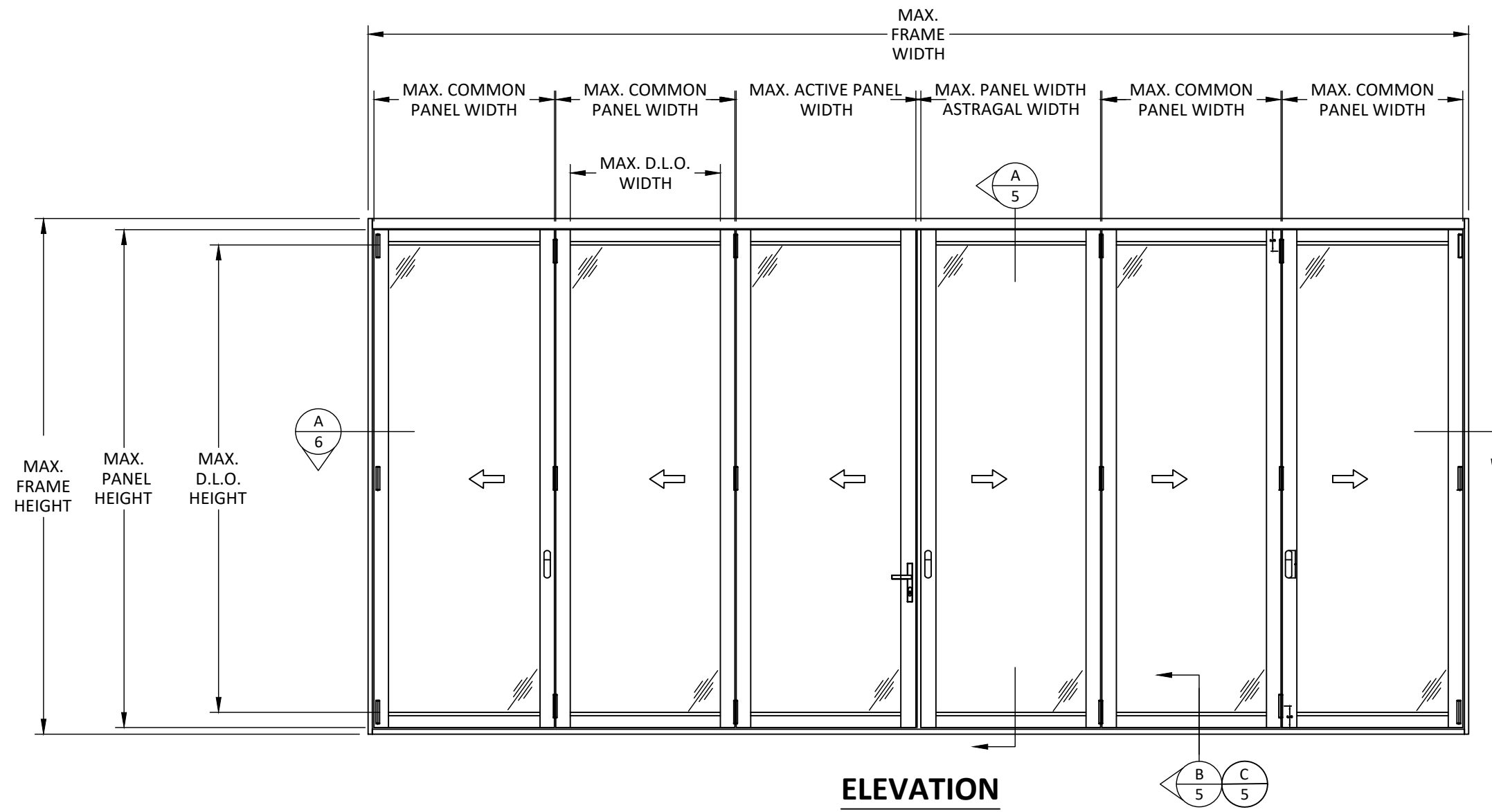

ELEVATION

NOTE:
SEE SHEET 3 FOR AVAILABLE
SIZES & CONFIGURATIONS
AND DESIGN PRESSURES.

| REMARKS | BY | DATE |
|-------------------|----|-------|
| 2023 CODE CHANGE | MG | 02/23 |
| COMPANY NAME UPD. | SH | 09/23 |
| DP TABLE UPDATES | SH | 12/23 |

THE INSTALLATION DETAILS DESCRIBED HEREIN ARE GENERIC AND MAY NOT REFLECT ACTUAL CONDITIONS FOR A SPECIFIC SITE. IF SITE CONDITIONS CAUSE INSTALLATION TO DEVIATE FROM THE REQUIREMENTS DETAILED HEREIN, A LICENSED ENGINEER OR ARCHITECT SHALL PREPARE SITE SPECIFIC DOCUMENTS FOR USE WITH THIS DOCUMENT.

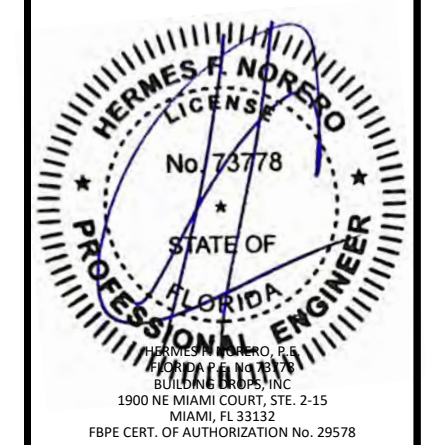

| | |
|----------|-----------------|
| FL #: | FL27023 |
| DATE: | 04.06.18 |
| DWG. BY: | HR |
| CHK. BY: | HFN |
| SCALE: | NTS |
| DWG. #: | EWS008 |
| SHEET: | 2 |

DESIGN PRESSURE TABLE

| DESIGN PRESSURE TABLE (+/- PSF) | | | | | | | | | | | | | | | | |
|---------------------------------|------------------------------|------|------|------|------|------|------|------|------|------|------|------|------|------|------|--|
| PANEL HEIGHT (INCHES) | NOMINAL PANEL WIDTH (INCHES) | | | | | | | | | | | | | | | |
| | 26 | 30 | 34 | 38 | 42 | 46 | 50 | 54 | 58 | 62 | 66 | 70 | 74 | 78 | 82 | |
| 91 | 50.0 | 50.0 | 50.0 | 50.0 | 50.0 | 45.7 | 42.0 | 38.9 | 36.2 | 33.9 | 31.8 | 30.0 | 28.4 | 26.9 | 25.6 | |
| 97 | 50.0 | 50.0 | 50.0 | 50.0 | 50.0 | 45.7 | 42.0 | 38.9 | 36.2 | 33.9 | 31.8 | 30.0 | 28.4 | 26.9 | 25.6 | |
| 103 | 50.0 | 50.0 | 50.0 | 50.0 | 50.0 | 45.7 | 42.0 | 38.9 | 36.2 | 33.9 | 31.8 | 30.0 | 28.4 | 26.9 | 25.6 | |
| 109 | 50.0 | 50.0 | 50.0 | 50.0 | 50.0 | 45.7 | 42.0 | 38.9 | 36.2 | 33.9 | 31.8 | 30.0 | 28.4 | 26.9 | 25.6 | |
| 115 | 50.0 | 50.0 | 50.0 | 50.0 | 50.0 | 45.7 | 42.0 | 38.9 | 36.2 | 33.9 | 31.8 | 30.0 | 28.4 | 26.9 | 25.6 | |
| 121 | 50.0 | 50.0 | 50.0 | 47.0 | 42.9 | 39.5 | 36.8 | 34.4 | 32.5 | 30.8 | 29.4 | 28.1 | 27.1 | 26.2 | 25.4 | |
| 127 | 50.0 | 50.0 | 44.9 | 40.5 | 36.9 | 34.0 | 31.6 | 29.6 | 27.8 | 26.4 | 25.1 | 24.0 | 23.1 | 22.2 | 21.5 | |
| 133 | 50.0 | 43.9 | 39.0 | 35.1 | 32.0 | 29.5 | 27.4 | 25.6 | 24.1 | 22.8 | 21.6 | 20.7 | 19.8 | 19.1 | 18.4 | |
| 139 | 44.1 | 38.4 | 34.1 | 30.7 | 27.9 | 25.7 | 23.8 | 22.3 | 20.9 | 19.8 | 18.8 | 17.9 | 17.2 | 16.5 | 15.9 | |
| 145 | 38.8 | 33.8 | 30.0 | 27.0 | 24.5 | 22.6 | 20.9 | 19.5 | 18.3 | 17.3 | 16.4 | 15.7 | 15.0 | 14.4 | 13.9 | |
| 151 | 34.3 | 29.9 | 26.5 | 23.8 | 21.7 | 19.9 | 18.4 | 17.2 | 16.2 | 15.2 | 14.5 | 13.8 | 13.2 | 12.6 | 12.2 | |
| 157 | 30.5 | 26.6 | 23.5 | 21.2 | 19.2 | 17.7 | 16.4 | 15.3 | 14.3 | 13.5 | 12.8 | 12.2 | 11.6 | 11.1 | 10.7 | |
| 163 | 27.3 | 23.7 | 21.0 | 18.9 | 17.2 | 15.7 | 14.6 | 13.6 | 12.7 | 12.0 | 11.4 | 10.8 | 10.3 | 9.9 | 9.5 | |
| 169 | 24.4 | 21.2 | 18.8 | 16.9 | 15.4 | 14.1 | 13.0 | 12.1 | 11.4 | 10.7 | 10.1 | 9.6 | 9.2 | 8.8 | 8.5 | |
| 175 | 22.0 | 19.1 | 16.9 | 15.2 | 13.8 | 12.7 | 11.7 | 10.9 | 10.2 | 9.6 | 9.1 | 8.6 | 8.2 | 7.9 | 7.6 | |

NOTE:
SIZE SHOWN ABOVE IS BASED ON TESTING, OTHER APPROVED CONFIGURATIONS ARE AS FOLLOWS:

- 1 PANEL - 1L, 1R
- 2 PANEL - 2L, 2R, 1L 1R
- 3 PANEL - 3L, 3R, 2L 1R, 1L 2R
- 4 PANEL - 4L, 4R, 3L 1R, 1L 3R, 2L 2R
- 5 PANEL - 5L, 5R, 4L 1R, 1L 4R, 3L 2R, 2L 3R
- 6 PANEL - 6L, 6R, 5L 1R, 1L 5R 4L 2R, 2L 4R, 3L 3R,
- 7 PANEL - 7L, 7R, 6L-1R, 1L-6R, 5L-2R, 2L-5R, 4L-3R, 3L-4R
- 8 PANEL - 8L, 8R, 7L-1R, 1L-7R, 6L-2R, 2L-6R, 5L-3R, 3L-5R, 4L-4R

INDIVIDUAL PANEL HEIGHT AND WIDTH SHALL NOT EXCEED THE HEIGHT AND WIDTH OF THE DIMENSIONS SHOWN ABOVE.

NOTE:
D.L.O. HEIGHT = PANEL HEIGHT - 6.65
D.L.O. WIDTH = PANEL WIDTH - 6.75

TITLE: EURO C5 OUT FOLDING DOOR SYSTEM (NON-HVHZ) (NON-IMPACT)

DESIGN PRESSURE TABLE

PREPARED BY: BUILDING DROPS, INC.
1900 NE MIAMI COURT, STE. 2-15
MIAMI, FL 33132
PH: (954)399-8478
FAX: (954)744-4738
WEB: www.buildingdrops.com



| REMARKS | BY | DATE |
|-------------------|----|-------|
| 2023 CODE CHANGE | MG | 02/23 |
| COMPANY NAME UPD. | SH | 09/23 |
| DP TABLE UPDATES | SH | 12/23 |

THE INSTALLATION DETAILS DESCRIBED HEREIN ARE GENERIC AND MAY NOT REFLECT ACTUAL CONDITIONS FOR A SPECIFIC SITE. IF SITE CONDITIONS CAUSE INSTALLATION TO DEVIATE FROM THE REQUIREMENTS DETAILED HEREIN, A LICENSED ENGINEER OR ARCHITECT SHALL PREPARE SITE SPECIFIC DOCUMENTS FOR USE WITH THIS DOCUMENT.



FL #: **FL27023**

DATE: **04.06.18**

DWG. BY: **HR** CHK. BY: **HFN**

SCALE: **NTS**

DWG. #: **EWS008**

SHEET: **3** OF 7

TITLE:
EURO C5 OUT FOLDING DOOR SYSTEM
(NON-HVHZ) (NON-IMPACT)

ANCHOR LAYOUTS

PREPARED BY:
BUILDING DROPS, INC.

1900 NE MIAMI COURT, STE. 2-15
MIAMI, FL 33132
PH: (954)399-8478
FAX: (954)744-4738
WEB: www.buildingdrops.com



| REMARKS | BY | DATE |
|-------------------|----|-------|
| 2023 CODE CHANGE | MG | 02/23 |
| COMPANY NAME UPD. | SH | 09/23 |
| DP TABLE UPDATES | SH | 12/23 |

THE INSTALLATION DETAILS DESCRIBED HEREIN ARE GENERIC AND MAY NOT REFLECT ACTUAL CONDITIONS FOR A SPECIFIC SITE. IF SITE CONDITIONS CAUSE INSTALLATION TO DEVIATE FROM THE REQUIREMENTS DETAILED HEREIN, A LICENSED ENGINEER OR ARCHITECT SHALL PREPARE SITE SPECIFIC DOCUMENTS FOR USE WITH THIS DOCUMENT.



FL #:
FL27023

DATE: **04.06.18**

DWG. BY: **HR** CHK. BY: **HFN**

SCALE: **NTS**

DWG. #: **EWS008**

SHEET:

4

OF 7

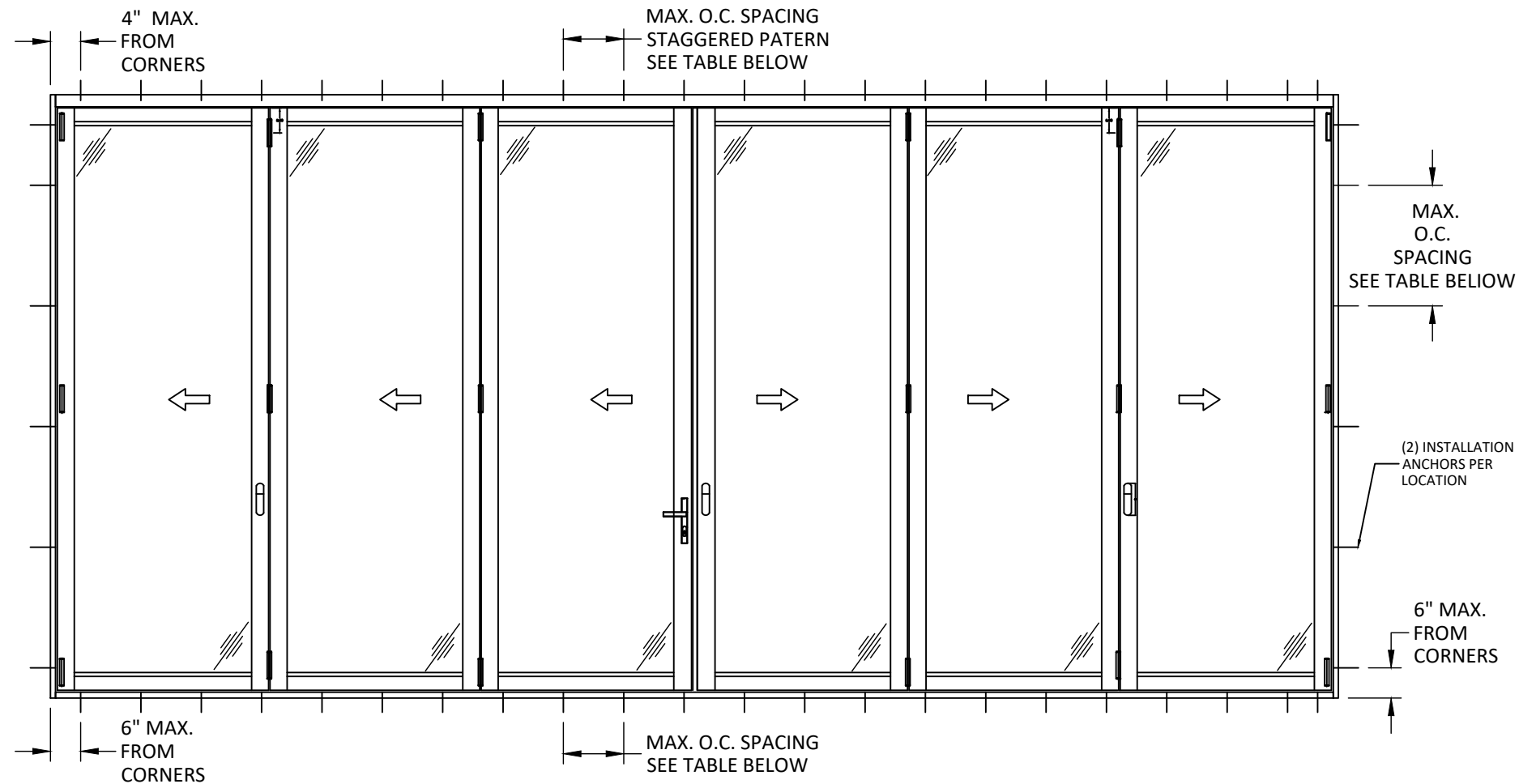

**ANCHOR LAYOUT
THROUGH FRAME INSTALLATION**

| SUBSTRATE | ANCHOR SCHEDULE | MAX. O.C. SPACING AT HEAD | MAX. O.C. SPACING AT SILL | MAX. O.C. SPACING AT JAMBS |
|--|-----------------|---------------------------|---------------------------|----------------------------|
| WOOD: MIN. SG = 0.55 | #14 WOOD SCREW | 12" | 12" | 24" |
| METAL: 18 GAUGE STEEL, MIN. Fy = 33KSI | 1/4" TEK SCREW | 11" | 11" | 18" |
| CONCRETE: fc=3000PSI | 1/4" ITW TAPCON | 12" | 12" | 24" |
| MASONRY: CMU PER ASTM C90 | 1/4" ITW TAPCON | 9.75" | 9.75" | 24" |

s:\projects\euro-wall systems\fb-23-1121 - fbc submittal - non-impact aluminum products design table updates\dwg\127023\ews008.dwg

12/8/2023 10:52 AM

12/8/2023 10:52 AM
s:\projects\euro-wall systems\fbc-23-1121 - fbc submittal - non-impact aluminum products design pressure table updates\dwgs\127023\ews008.dwg

TITLE:
EURO C5 OUT FOLDING DOOR SYSTEM
(NON-HVHZ) (NON-IMPACT)

VERTICAL SECTIONS

PREPARED BY:
BUILDING DROPS, INC.

1900 NE MIAMI COURT, STE. 2-15
MIAMI, FL 33132
PH: (954) 399-8478
FAX: (954) 744-4738
WEB: www.buildingdrops.com



| REMARKS | BY | DATE |
|-------------------|----|-------|
| 2023 CODE CHANGE | MG | 02/23 |
| COMPANY NAME UPD. | SH | 09/23 |
| DP TABLE UPDATES | SH | 12/23 |

THE INSTALLATION DETAILS DESCRIBED HEREIN ARE GENERIC AND MAY NOT REFLECT ACTUAL CONDITIONS FOR A SPECIFIC SITE. IF SITE CONDITIONS CAUSE INSTALLATION TO DEVIATE FROM THE REQUIREMENTS DETAILED HEREIN, A LICENSED ENGINEER OR ARCHITECT SHALL PREPARE SITE SPECIFIC DOCUMENTS FOR USE WITH THIS DOCUMENT.



FL #:
FL27023

DATE: **04.06.18**

DWG. BY: **HR** CHK. BY: **HFN**

SCALE: **NTS**

DWG. #: **EWS008**

SHEET:

5

OF 7

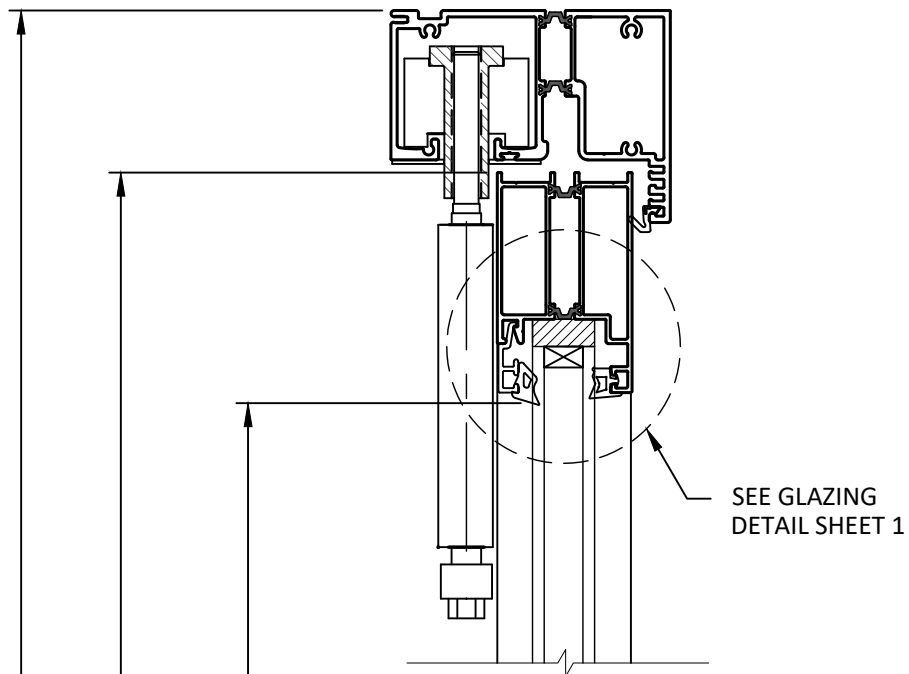

O.A. FRAME HEIGHT MAX. PANEL HEIGHT MAX. D.L.O. HEIGHT EXTERIOR INTERIOR

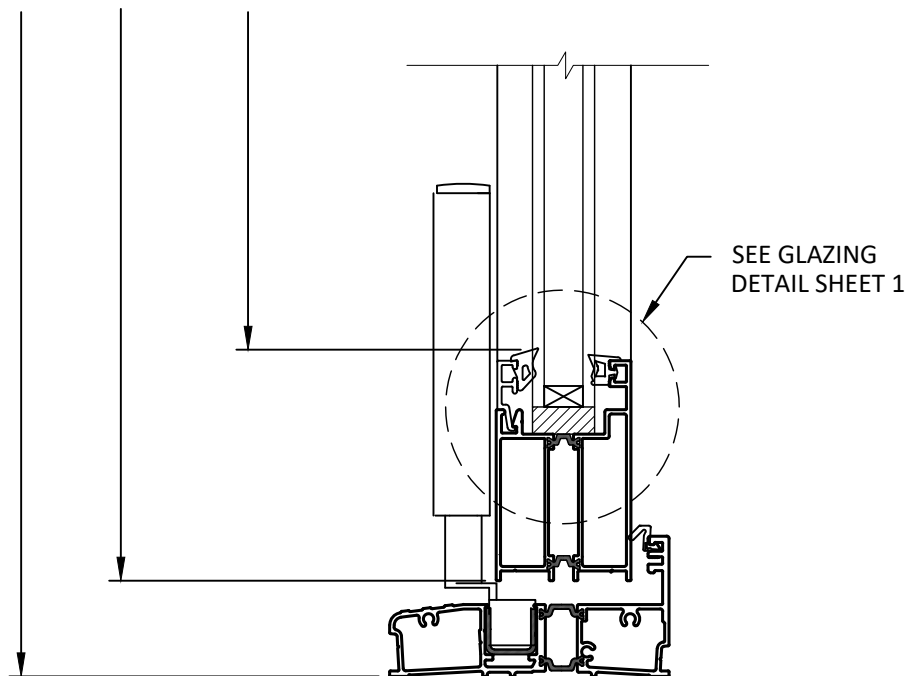

A
5 **VERTICAL SECTION**
STANDARD SILL - WATER RATED

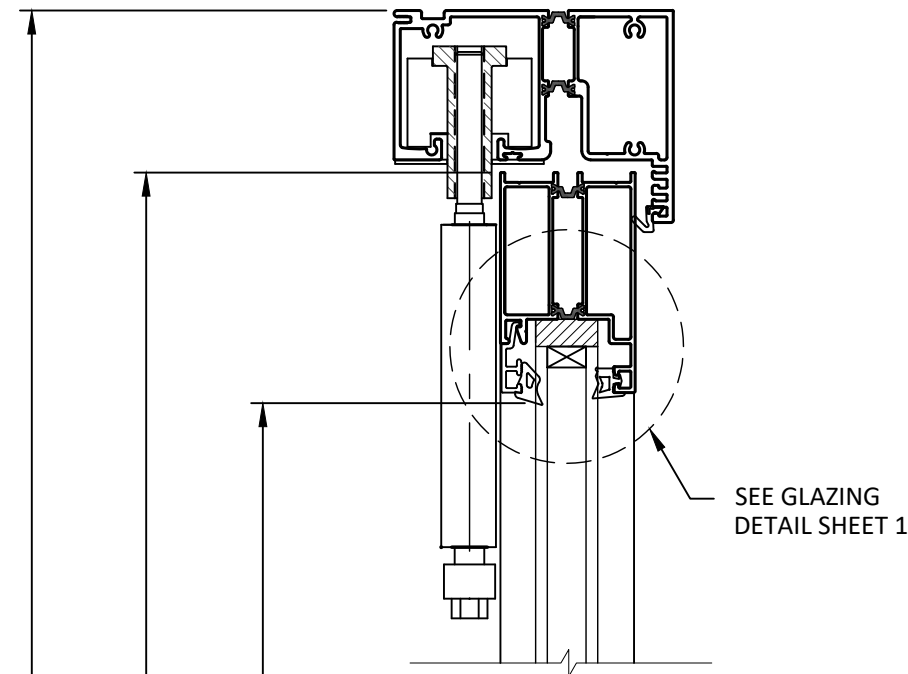

O.A. FRAME HEIGHT MAX. PANEL HEIGHT MAX. D.L.O. HEIGHT EXTERIOR INTERIOR

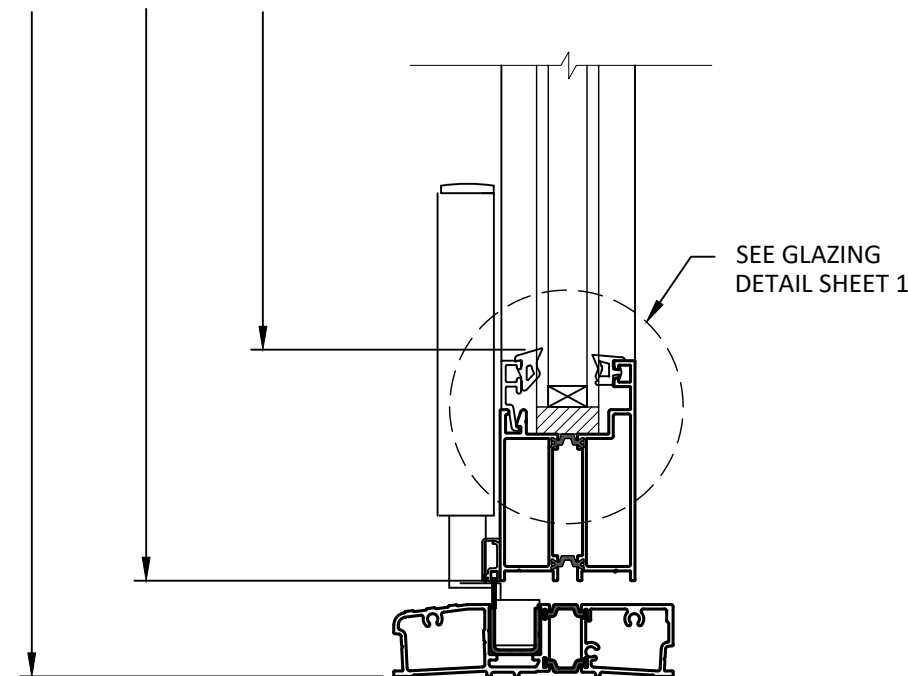

B
5 **VERTICAL SECTION**
MODIFIED STANDARD SILL - NOT RATED FOR WATER

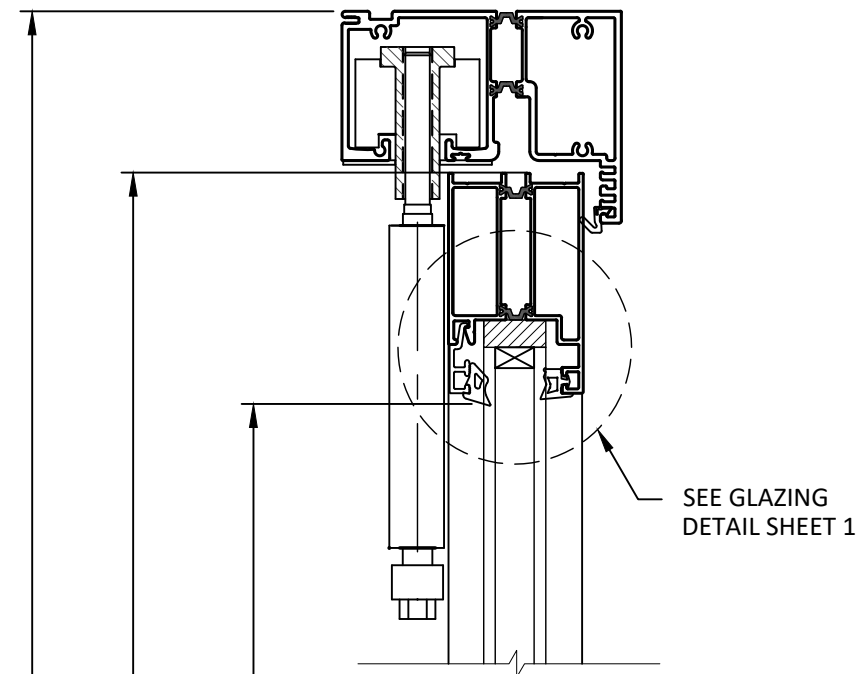

O.A. FRAME HEIGHT MAX. PANEL HEIGHT MAX. D.L.O. HEIGHT EXTERIOR INTERIOR

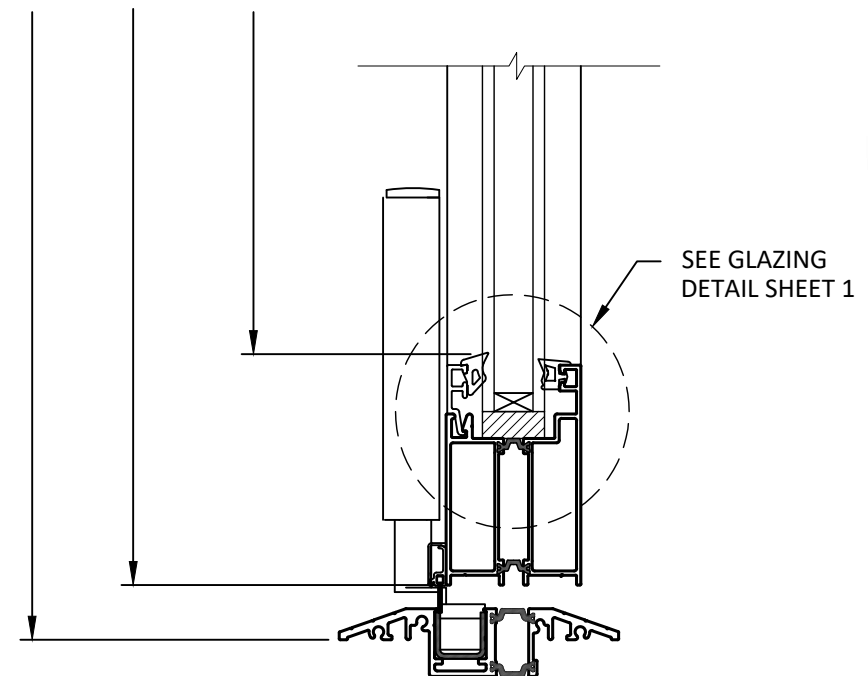

C
5 **VERTICAL SECTION**
ADA SILL - NOT RATED FOR WATER

12/8/2023 10:52 AM
s:\projects\euro-wall systems\fbc-23-1121 - fbc submittal - non-impact aluminum products design pressure table updates\dwgs\127023\ews008.dwg

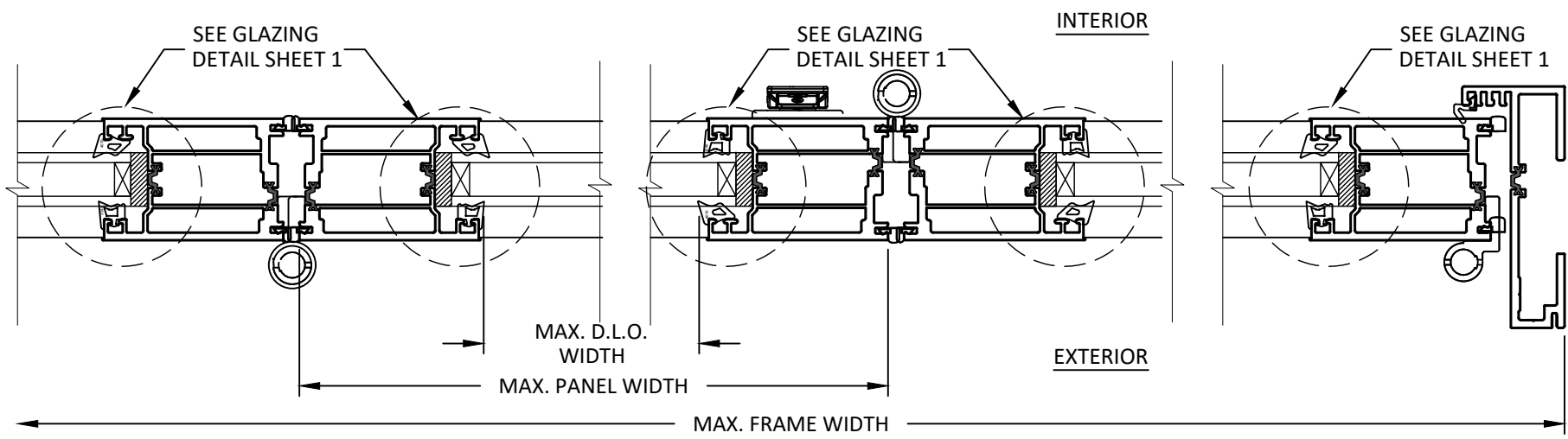
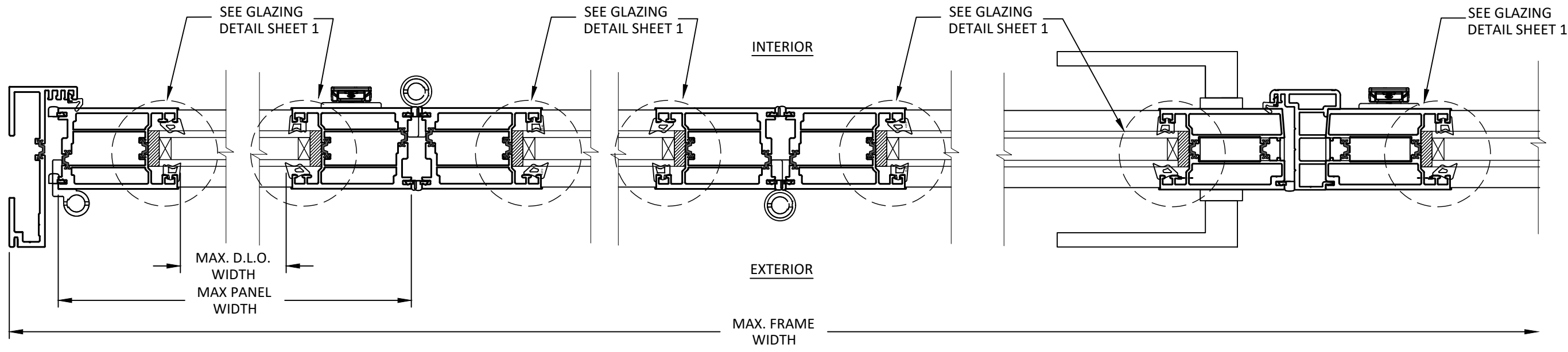

A HORIZONTAL SECTION
6 THROUGH FRAME INSTALLATION

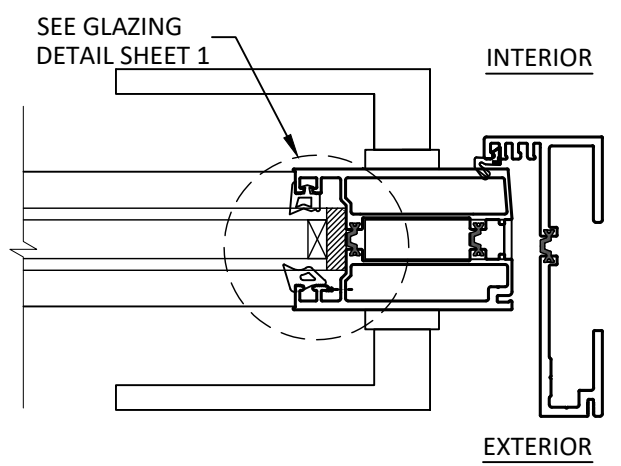

B HORIZONTAL SECTION
6 THROUGH FRAME INSTALLATION

NOTE:
1. DETAIL B/6 IS APPLICABLE FOR CONFIGURATIONS LISTED ON SHEET 3 WHERE FREE PANELS LOCK TO THE JAMB.

euro-wall
SUPERIOR BY DESIGN

EURO-WALL, LLC
P.O. BOX 8007
NORTH PORT, FL 34290
PH: 888-989-3876

TITLE:
EURO C5 OUT FOLDING DOOR SYSTEM
(NON-HVHZ) (NON-IMPACT)

HORIZONTAL SECTIONS

PREPARED BY:
BUILDING DROPS, INC.
1900 NE MIAMI COURT, STE. 2-15
MIAMI, FL 33132
PH: (954) 399-8478
FAX: (954) 744-4738
WEB: www.buildingdrops.com



| REMARKS | BY | DATE |
|-------------------|----|-------|
| 2023 CODE CHANGE | MG | 02/23 |
| COMPANY NAME UPD. | SH | 09/23 |
| DP TABLE UPDATES | SH | 12/23 |

THE INSTALLATION DETAILS DESCRIBED HEREIN ARE GENERIC AND MAY NOT REFLECT ACTUAL CONDITIONS FOR A SPECIFIC SITE. IF SITE CONDITIONS CAUSE INSTALLATION TO DEVIATE FROM THE REQUIREMENTS DETAILED HEREIN, A LICENSED ENGINEER OR ARCHITECT SHALL PREPARE SITE SPECIFIC DOCUMENTS FOR USE WITH THIS DOCUMENT.

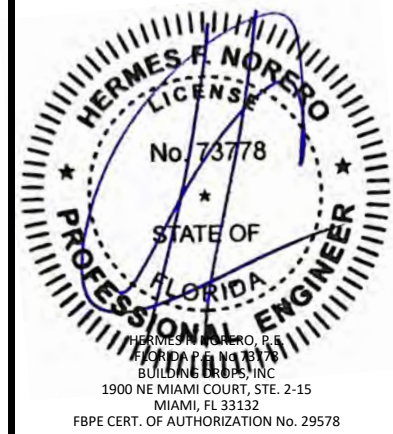

FL #:
FL27023

DATE: **04.06.18**

DWG. BY: **HR** CHK. BY: **HFN**

SCALE: **NTS**

DWG. #: **EWS008**

SHEET:

6

OF 7

12/8/2023 10:52 AM

s:\projects\euro-wall systems\fbc-23-1121 - fbc submittal - non-impact aluminum products design pressure table updates\dwgs\127023\ews008.dwg

TITLE:
EURO C5 OUT FOLDING DOOR SYSTEM
(NON-HVHZ) (NON-IMPACT)

INSTALLATION NOTES, ANCHOR
DETAILS & SCHEDULE

PREPARED BY:
BUILDING DROPS, INC.
1900 NE MIAMI COURT, STE. 2-15
MIAMI, FL 33132
PH: (954) 399-8478
FAX: (954) 744-4738
WEB: www.buildingdrops.com



| REMARKS | BY | DATE |
|-------------------|----|-------|
| 2023 CODE CHANGE | MG | 02/23 |
| COMPANY NAME UPD. | SH | 09/23 |
| DP TABLE UPDATES | SH | 12/23 |

THE INSTALLATION DETAILS DESCRIBED HEREIN ARE GENERIC AND MAY NOT REFLECT ACTUAL CONDITIONS FOR A SPECIFIC SITE. IF SITE CONDITIONS CAUSE INSTALLATION TO DEVIATE FROM THE REQUIREMENTS DETAILED HEREIN, A LICENSED ENGINEER OR ARCHITECT SHALL PREPARE SITE SPECIFIC DOCUMENTS FOR USE WITH THIS DOCUMENT.

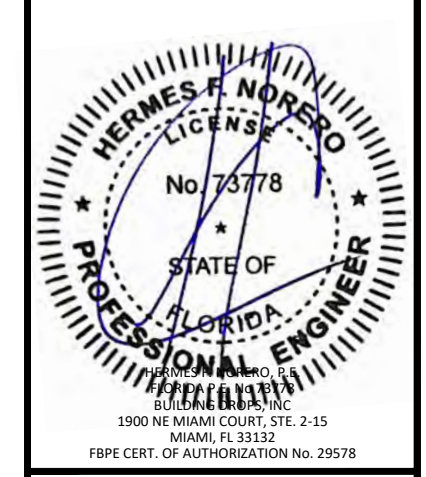

FL #:

FL27023

DATE: **04.06.18**

DWG. BY: **HR** CHK. BY: **HFN**

SCALE: **NTS**

DWG. #: **EWS008**

SHEET:

7

OF 7

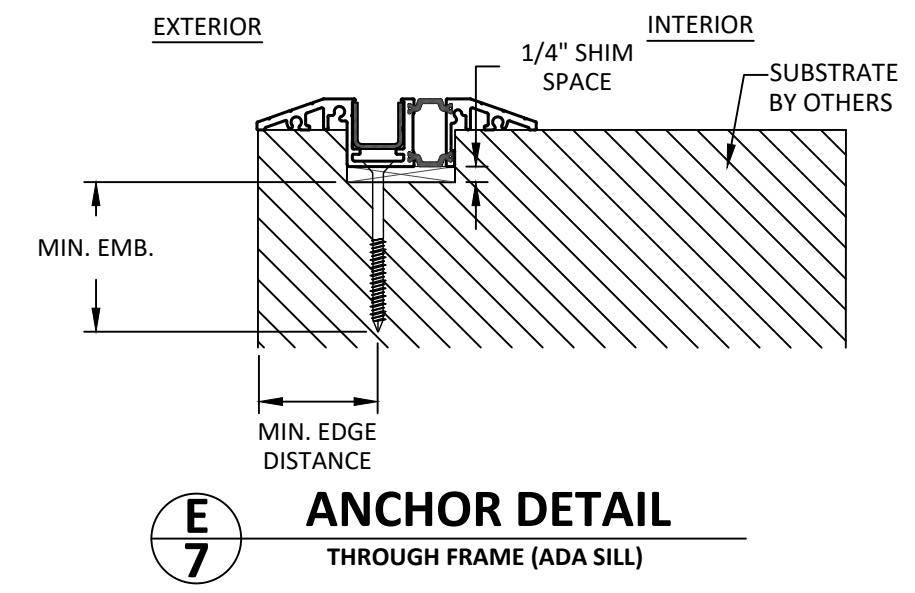
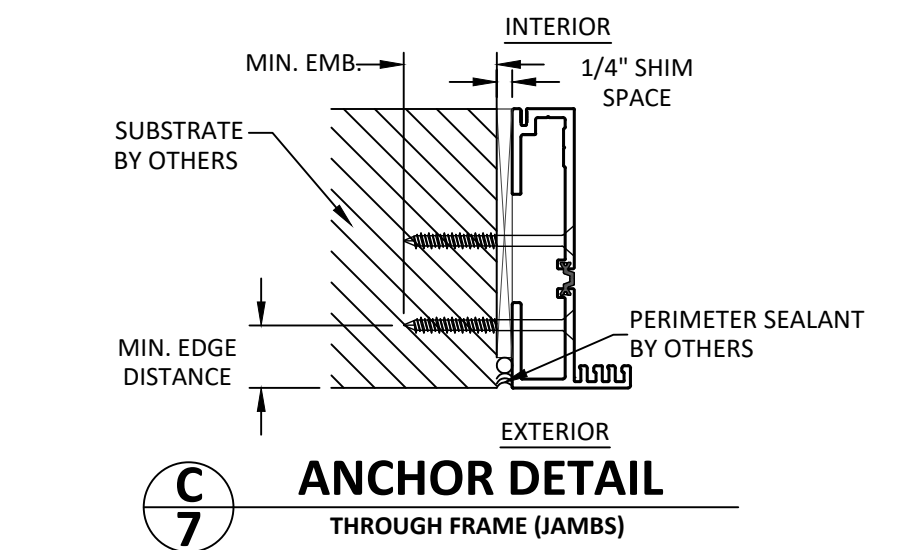
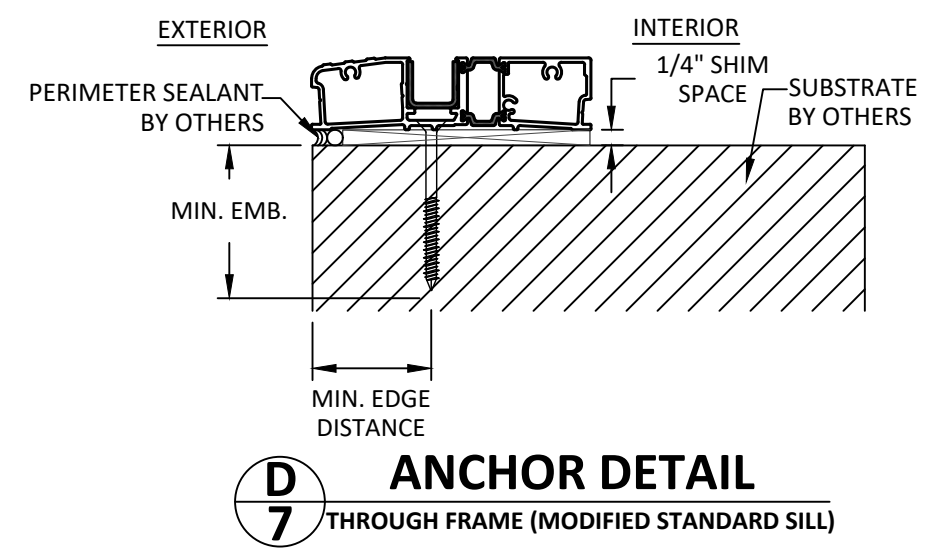
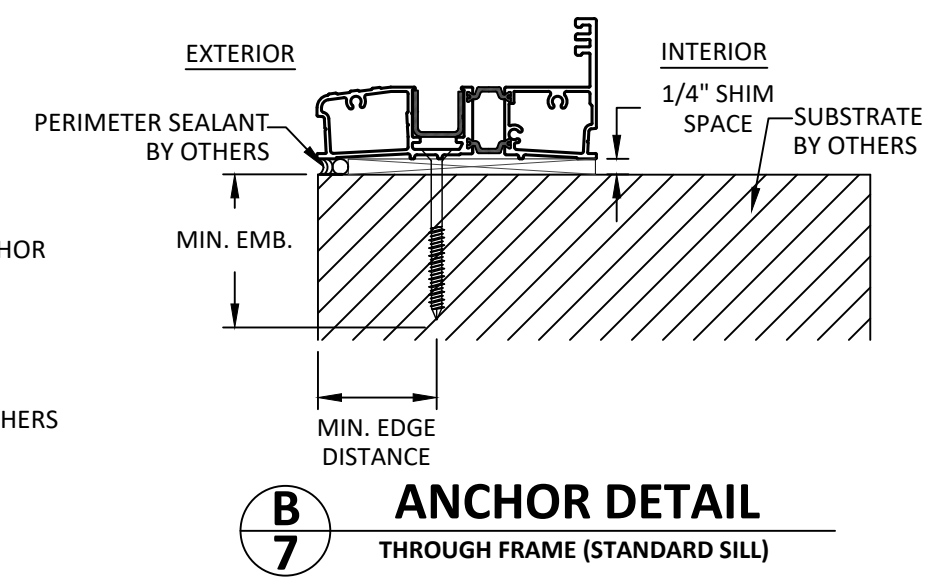
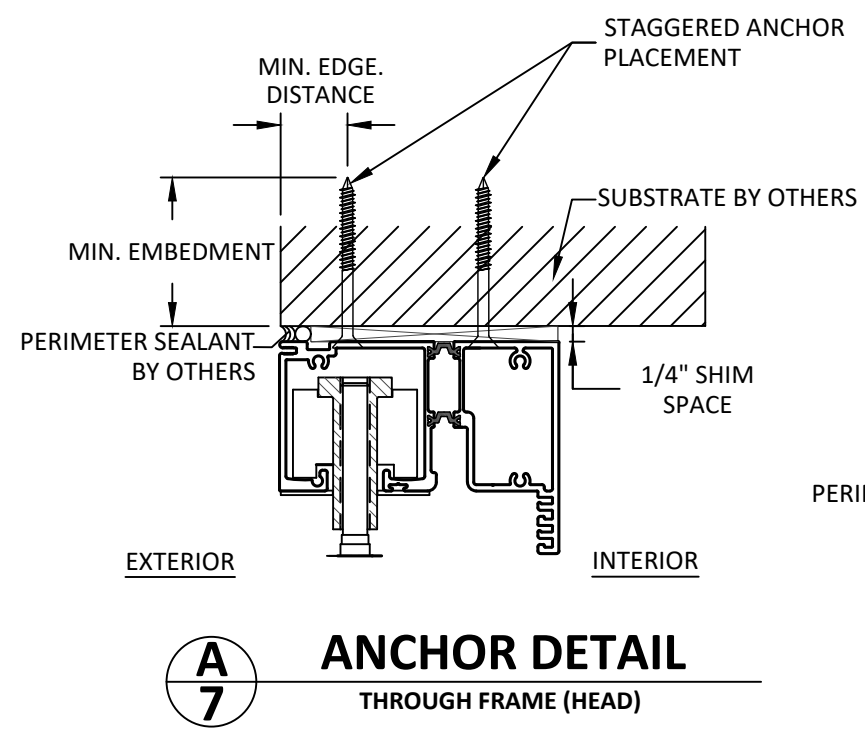

INSTALLATION NOTES:

- ONE (1) INSTALLATION ANCHOR IS REQUIRED AT EACH ANCHOR LOCATION SHOWN UNLESS SPECIFIED IN THE ANCHOR SCHEDULE. TWO (2) INSTALLATION ANCHORS AT THE JAMBS AND HEAD.
- THE NUMBER OF INSTALLATION ANCHORS DEPICTED IS THE MINIMUM NUMBER OF ANCHORS TO BE USED FOR PRODUCT INSTALLATION OF THE MAXIMUM SIZE LISTED.
- INSTALL INDIVIDUAL INSTALLATION ANCHORS WITHIN A TOLERANCE OF ±1/2 INCH THE DEPICTED LOCATION & SPACING IN THE ANCHOR LAYOUT DETAILS (I.E., WITHOUT CONSIDERATION OF TOLERANCES). TOLERANCES ARE NOT CUMULATIVE FROM ONE INSTALLATION ANCHOR TO THE NEXT.
- SHIM AS REQUIRED AT EACH INSTALLATION ANCHOR WITH LOAD BEARING SHIM(S). MAXIMUM ALLOWABLE SHIM STACK TO BE 1/4 INCH. SHIM WHERE SPACE OF 1/16 INCH OR GREATER OCCURS. SHIM(S) SHALL BE CONSTRUCTED OF HIGH DENSITY PLASTIC OR BETTER.
- FOR MASONRY OR CONCRETE OPENINGS, 1X WOOD BUCK MAY BE USED (OPTIONAL AS LONG AS THE MINIMUM EMBEDMENT AND EDGE DISTANCE REQUIREMENTS ARE STILL MET WITHIN THE CORRESPONDING HOST SUBSTRATE.) SEE GENERAL NOTE #3 ON SHEET 1 FOR MORE INFORMATION.
- MINIMUM EMBEDMENT AND EDGE DISTANCE EXCLUDE WALL FINISHES, INCLUDING BUT NOT LIMITED TO STUCCO, FOAM, BRICK VENEER, AND SIDING.
- INSTALLATION ANCHORS AND ASSOCIATED HARDWARE MUST BE MADE OF CORROSION RESISTANT MATERIAL OR HAVE A CORROSION RESISTANT COATING.
- FOR HOLLOW BLOCK AND GROUT FILLED BLOCK, DO NOT INSTALL INSTALLATION ANCHORS INTO MORTAR JOINTS. EDGE DISTANCE IS MEASURED FROM FREE EDGE OF BLOCK OR EDGE OF MORTAR JOINT INTO FACE SHELL OF BLOCK.
- INSTALLATION ANCHORS SHALL BE INSTALLED IN ACCORDANCE WITH ANCHOR MANUFACTURER'S INSTALLATION INSTRUCTIONS, AND ANCHORS SHALL NOT BE USED IN SUBSTRATES WITH STRENGTHS LESS THAN THE MINIMUM STRENGTH SPECIFIED BY THE ANCHOR MANUFACTURER.
- SILL SHALL BE SET IN A BED OF STRUCTURAL SILICONE.

| ANCHOR SCHEDULE | | | | |
|-----------------|--|-----------------|--|--------------------|
| METHOD | SUBSTRATE | ANCHOR SCHEDULE | MIN EMBEDMENT | MIN. EDGE DISTANCE |
| THROUGH FRAME | WOOD: MIN. SG = 0.55 | #14 WOOD SCREW | 1.5" | 0.75" |
| | METAL: 18 GAUGE STEEL, MIN. Fy = 33KSI | 1/4" TEK SCREW | 3 THREADS MIN PENETRATION BEYOND METAL | 0.5" |
| | CONCRETE: fc=3000PSI | 1/4" ITW TAPCON | 1.75" | 2.5" |
| | MASONRY: CMU PER ASTM C90 | 1/4" ITW TAPCON | 1.75" | 3" |